

SEPT. MEETING
AT MISCHKE'S
2316 N. 113 Pl.
8:00 PM
Sept. 16
see map →

THE CASCADE CAVER
Vol. VII
September
Official publication of the
Cascade Grotto of the National
Speleological Society
1117 38th Ave. E., Seattle, Wn. 98102

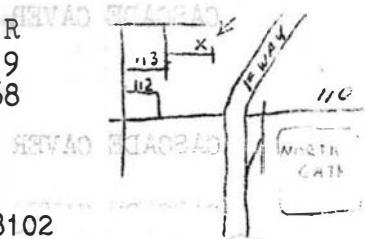

MARCH CAVE HUNT IN WHATCOM COUNTY by Jan Roberts

Sunday, March 2nd, 8 cavers made a trip to Whatcom County and the limestone deposits of Red Mountain. The deposits examined were: Silver Lake Quarry; Silver Lake #2, $\frac{1}{2}$ mile north of the Silver Lake Quarry. We ran out of time and were not able to visit the Permanente Quarry.

On this trip there were: myself; Luurt Niewenhuis and friend Rick; Charlie Anderson and his friend, Ken; Bob Brown and his friend Collette, all in Bob's Rambler Stionwagon, and Cascade Grotto chairman Rick Rigg in his camper pickup.

After we had lunch in Maple Falls, we travelled north about 3 miles to the Silver Lake Quarry. We spent about an hour looking around, but no new sinkholes (or caves) were found. Cliff Rouleau, Quarry Supt., told us that there are several cave entrances blocked through in the quarry wall including a cave that was thought previously (CASCADE CAVER Vol. VI, N^o. 5, May 1967) to have been quarried away. Mr. Rouleau said that this cave was still in existence, that it had stalactites, but could not be entered due to quarrying. We had planned originally to rappel down the quarry wall into one cave entrance that I had heard about earlier (Gordon Clauson, Pres. of Everett Lime Co., oral comm, 1968). However, a look at the quarry wall quickly persuaded us that suits of armor might be in order for protection from falling rock. This deposit can be eliminated from the list of limestone deposits to be looked at.

The next area of limestone to the north of the quarry required a land-owner's permission for access. An old logging road took us to this deposit. Several sinkholes and fissures are present although no amount of digging yielded a cave. We were unable to find the tufa depositing stream and the strong draft of air emerging from talus (although we found a large talus area) mentioned by Ted Danner in his report. If I go back to this area again, Ted Danner will be with me. It's often easier to find informants than it is to find what they have found, as I have discovered.

Next we drove north, around Red Mountain in hopes of visiting the Permanente Cement quarry. Alas, the gate on the road to the quarry was locked and not a key-bearing Supt. around. It was too late in the day to hike the three miles to the quarry from the gate, so homeward bound we went, satisfied in our efforts despite the fact that we found no caves on that rainy day.

DAN YR OGOR CAVES, SOUTH WALES by Rob and Kay Stitt

During August, in addition to the several caves Kay visited in Southern Europe (to be described in a future issue of the CAVER), we visited the cave of Dan Yr Ogof, a relatively unspectacular (at least in the tourist section) limestone in the Swansea valley in South Wales, Great Britain. The few hundred feet of cave on the tourist section of this cave were quite average, and in this country, outside of the Black Hills would probably not be worth commercializing. However, recent work by the South Wales Caving Club has brought to light several miles of additional passage, reachable only through a floodable passage traversing several large lakes, and containing such spectacular things as helectites SEVEN FEET long, forests of soda straws that long, and a possibility for more passage. This discovery, coupled with other discoveries in South Wales, including that of over 14 miles of passage in another nearby cave, make this sound like a very exciting caving area indeed!

CAVING WITH B & C

COURTESY OF THE GEM STATE GROTTOS



WOULD YOU BELIEVE, I'M A
CAVERS WIFE.?



IT IS NICE - KNOWING
MY HUSBAND IS THE
ADVENTUROUS TYPE!



OF COURSE THERE ARE MISGIVINGS.
NO LONGER AM I THE CENTER OF
ATTENTION. HE LEAVES ME ALONE FOR
DAYS AT A TIME.



BY DAMN! I'LL
GET EVEN. I'M
BECOMING A
HYDROCONDRIAC!

You may have noticed that this issue of the CAVER, while the largest so far this year, does not necessarily contain the most information. A possible reason for this is that there is no information to impart, but I can hardly believe that this is true, since there is a relatively high amount of speleological activity going on at present. If even $\frac{1}{2}$ of the trips which have been scheduled have been even $\frac{1}{2}$ way successful, we should have so much information to impart that we would wear out our trusty mimeograph machine, let alone typewriter and typist.

The problem appears to be that those who have the information are somewhat reluctant to part with it, probably because of sheer laziness. During the tenure of the previous editor of this paper, it is interesting to note that 90% of the contents was provided by only 2 individuals, the editor himself and Bill Halliday, with a large number of reprints from other sources. Due to limitations in our reproduction process (the Pope's recent pronouncement had no effect) we are now unable to easily include reprints from other sources, however, and must rely on typewritten and hand drawn material.

Therefore, in order to increase the flow of information, we have included in this issue samples of several forms which are now available to members of the Grotto. It is hoped that especially the LOG form will be utilized by everyone. This will enable the easy inclusion of trip reports in the CAVER. In addition, the new cave reporting form will greatly aid in a compilation of all the caves in the Northwest, and the Advance trip report form will aid you, yourself, in assuring that information is available to would-be rescuers in case you should get into trouble while caving. A copy of the ADVANCE TRIP REPORT FORM should be filled out and left with a responsible person, with instructions that if you do not return or call in within a reasonable amount of time after your intended return time, they should notify the Northwest Cave Rescue Organization, the emergency call list of which is listed on the form.

This, of course, adds to the responsibility of the caver to call in if he is delayed so that a search will not be started by mistake. It is much better, however, that the information is available and an occasional false alarm is called than if no information is available and a life is lost due to inaction. This form becomes especially important in the case of small groups who are going to areas such as Cave Ridge.

...Just got back from Bill Halliday's, where I picked up a treasure trove of old material submitted to the CAVER over the past 10 years or so and never run. So here goes.....

Note: The editor of this rag is: Rob Stitt, 600 Lk. Wn. Blvd. E., Seattle W. 98102., and deadlines for material are: The 1st Tuesday of the Month. The paper is issued, normally, on the 2nd Tuesday of the Month.

CAVES OF NEBRASKA--PART III (God knows when parts I & II were)
(For the benefit of new subscribers, the CAVER has been running a series of articles on Nebraska caves so that Northwesterers won't feel so badly about our shortage of caves here.)

John Browns Cave, in west part of Nebraska City. "Actually dug by friends of John Brown" - p. 122, Visiting American Caves, by Sloan and Gurnee, 1966.





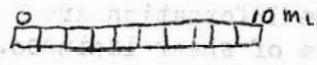

Robber's Cave, in south side of Lincoln, *ibid*, p. 123. Once called Pawnee Council Cave. According to Sloan and Gurnee and/or their informants, this cave is in the Dakota sandstone but has 500 feet of passage. Assuming that the accompanying picture is of the correct cave (one on p. 7 is labelled Russell Cave, Ala. but is actually Mammoth Cave, KY.) it looks like a pretty good phreatic cave and may be worth the 75¢ admission.

Harumph! End of Caves of Nebraska.

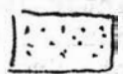
Riggins, Ida.
& vicinity

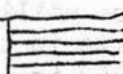
Scale: $\frac{1}{500,000}$

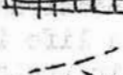

-  Quaternary Sand, gravel
-  Tertiary Columbia River Basalt
-  Triassic Sedimentary Rocks including Limestone
-  Permian-Triassic Volcanic Rocks
-  Border Zone of Idaho Batholith
-  Idaho Batholith Quartz-Monzonite ("Granite")
-  Various Units (Too complex for this map)
-  Faults

This map goes with the article on P. 32 (July Issue) on "Geology of the Riggins, Idaho Area, by Don Tubbs



CASCADE GROTTO ADVANCE TRIP REPORT FORM

DESTINATION (AREA OR CAVE): _____

PERSONS ATTENDING (NAME AND TELEPHONE NO.): _____

DEPARTURE TIME:
& DATE

RETURN TIME:
& DATE

CAR OR CARS (MAKE, YEAR, COLOR, AND MODEL): _____

PLANNED PARKING AREA: _____

PLANNED ROUTE TO CAVE FROM PARKING AREA: _____

CAVES TO BE VISITED OR AREA TO BE SEARCHED: _____

ADDITNAL INFO: _____

IN CASE OF EMERGENCY CALL:

	Home	Work
1. Vern Frese	CH-4-1525	RO-2-8681
2. Bill Halliday	EA-4-7474	1-753-6372
3. Dave Moschke	EH-5-2614	655-8701
4. Dick Mitchell	AT-2-5340	654-6849
5. Chas. Anderson	MU-2-5399	MA-4-5180
6. Rick Rigg	AL-5-8567	773-4476

LEAVE THIS FROM WITH A RESPONSIBLE PERSON BEFORE LEAVING ON THE TRIP. Additional copies of the form may be obtained from the grotto Field Trip Chairman, and the filled out copy should be returned to him after the trip has been completed.

CASCADE GROTTO TRIP LOG

DATE: _____ CAVE(S) VISITED: _____

APPROX. LOCATION: _____

PERSONS ON TRIP: _____

TIME: START: _____ FINISH: _____

PURPOSE: _____

ACCOMPLISHED: _____

DISCOVERIES: _____

1888-1-1
5980-021-1
1078-249
0480-403
0012-403

SEND TO: CASCADE CAVER, 1117 36th Ave. E., Seattle, Wash., 98102. A copy of the report will be retained in Grotto files. Include copies of maps and any additional information available. This log will be used to compile articles for the CAVER. Additional copies are available from the Field Trip Chairman.

NEW CAVE REPORT FORM
(To be used only for reporting new cave locations and information.)

CAVE NAME(S): _____ STATE: _____

COUNTY: _____ TOWNSHIP: _____ RANGE: _____ SEC. _____

USGS QUAD: _____ LAT.: _____ LONG.: _____ ELEV.: _____

REPORT BY: _____ DATE OF REPORT: _____

REMARKS: _____

DIRECTIONS FOR REACHING CAVE:

NARRATIVE DESCRIPTION OF CAVE:

Monday, Sept. 16, 8:00 PM; Regular Meeting at MISCHKE'S, 2316 N. 113th Pl., Seattle (See Aug. issue for map, also upper right corner of this issue's front page.) Program: Oregon Caves and Gardner Cave, by C. Anderson.

Monday, Sept. 23, Northwest Cave Rescue Assoc., Cascade Unit, General meeting; at Halliday's, 8:00 PM (1117 36th E.)

Thursday, Sept. 26, 7:00 PM; NCRA Rescue Practice, at LAYRITE, 7265 E. Marginal Way S.; Bring equipment (ropes, slings, lights, hats, etc.)

Fri., Sat., & Sun., Sept. 27, 28, & 29; DYNAMITED Cave work trip, camp at Trout Lake Campground; with a Saturday nite SOCIAL FUNCTION. This will be a joint trip with the Oregon Grotto, & perhaps the first meeting on the Northwestern Regional Assoc. Contact Rob Stitt, EA-5-3357, for further info.

Monday, Sept. 30, 8:00 PM at Mischke's, 2316 N. 113th Pl, NCRA(Cascade) Board meeting

Sat., Sun. October 5 & 6; Field trip to McLaughlin Canyon CAVES, Okanogan Co., 5-10 mi. S. of Tenasket. A fissure cave rumored to be over 1200' deep and apparently quite large and complex.

Monday, October 7, 7:30 PM, Charlie Andersons, 420 Terry, Executive Board meeting.

October 12-13, Sat., Sun.--Cave Ridge trip, to finish gating projects and hopefully not get snowed upon.

At the Sept. Exec. Meeting, it was decided that effective Jan. 1, dues (Grotto) for non-NSS members would be 50% higher than those for NSS members. And NSS dues are going up OCT. 1., however if you join now (immediately) you can still get in for one year at the old rate,. So JOIN THE NSS NOW!!!!!!

A subscription to the CASCADE CAVER, if you live outside the Seattle area, is now \$2.00 per year, but this is probably going to go up in Jan. also. Also, if you are a subscriber, you will soon get your back issues, so please be patient. We are undergoing Grotto Growing Pains,

CASCADE CAVER
1117 36th Ave. E.
Seattle, Wn. 98102

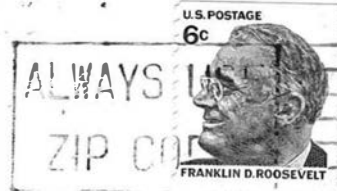

THIRD CLASS

David H. Branna
117 Dartmouth Ave
Tacoma Wash 98466

SAMPLE COPY